

PIN ASSIGNMENT:

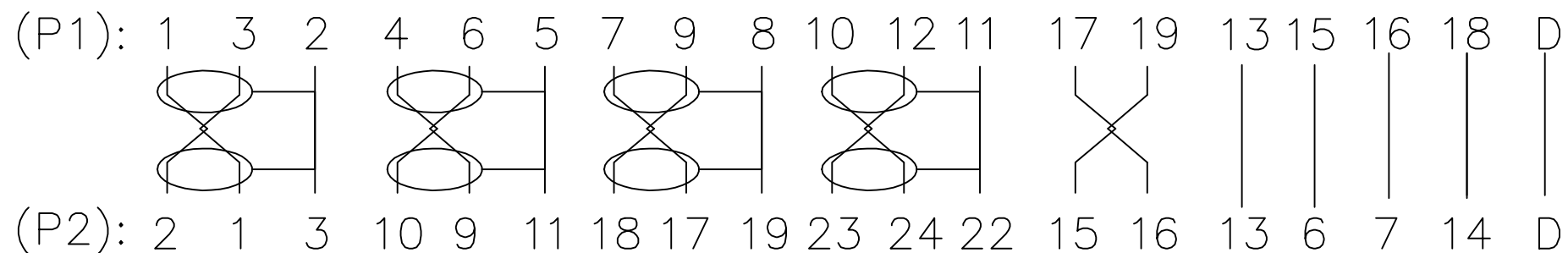

NOTES:

- 1.100%OPEN&SHORT TESTING
- 2.VOLTAGE:300V DC
- 3.INSULATION RESISTANCE:20M ohm
- 4.CONTACT RESISTANCE:1 ohm

8		
7		
6		SCREW: #4-40 BLACK
5		Outer Jacket: 45Pa PVC BLACK
4		Inner Jacket:PE
3		HDMI A MALE GOLD
2		DVI24+1 MALE GOLD
1		[30AWG*1P+D)+AL]*5PCS+30AWG*4C+DW+FILLER+AL+96B OD:7.3mm BLACK
NO.	Material	Description

Fairline Distribution Ltd.

Title:
HDMI TO DVI 24+1 CABLE M/M

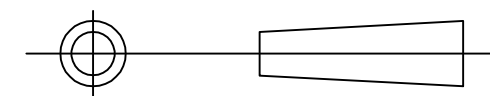

Customer: FDL

Page: 1/1

Drawn BY: CLR

Customer P/N: 1097-0xx

REV: A

Check BY: DYH

Date: 2021.09.07

Drawing NO.: FUAM01-1

Unit: mm

Appd BY: